

VISTA SUPERIOR (D10)

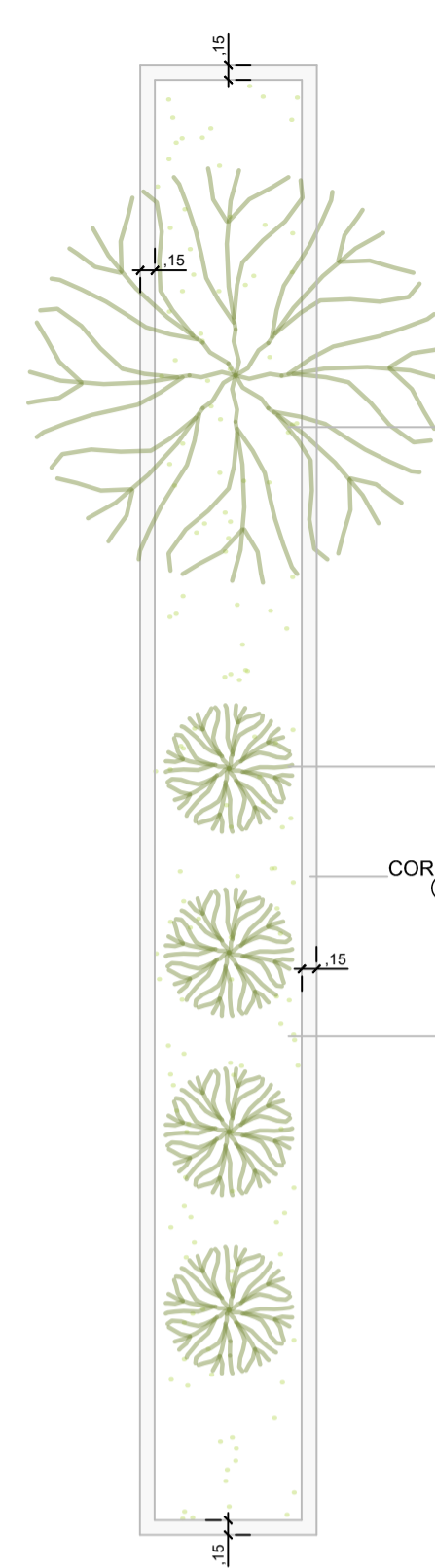

VISTA SUPERIOR (D10)

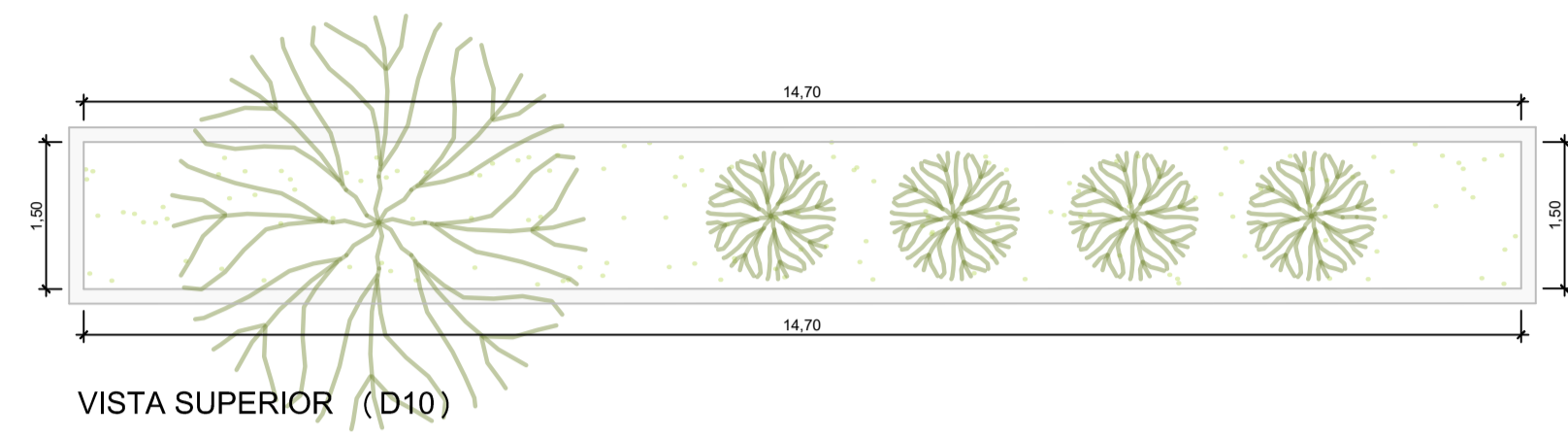

VISTA SUPERIOR (D10)



VISTA LONGITUDINAL (D10)

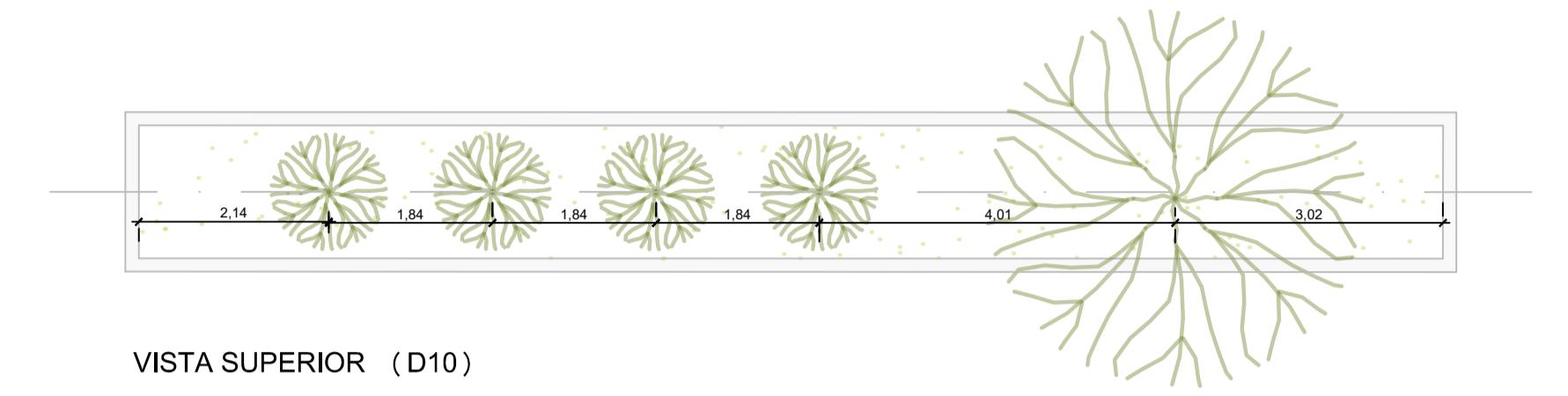

VISTA SUPERIOR (D10)

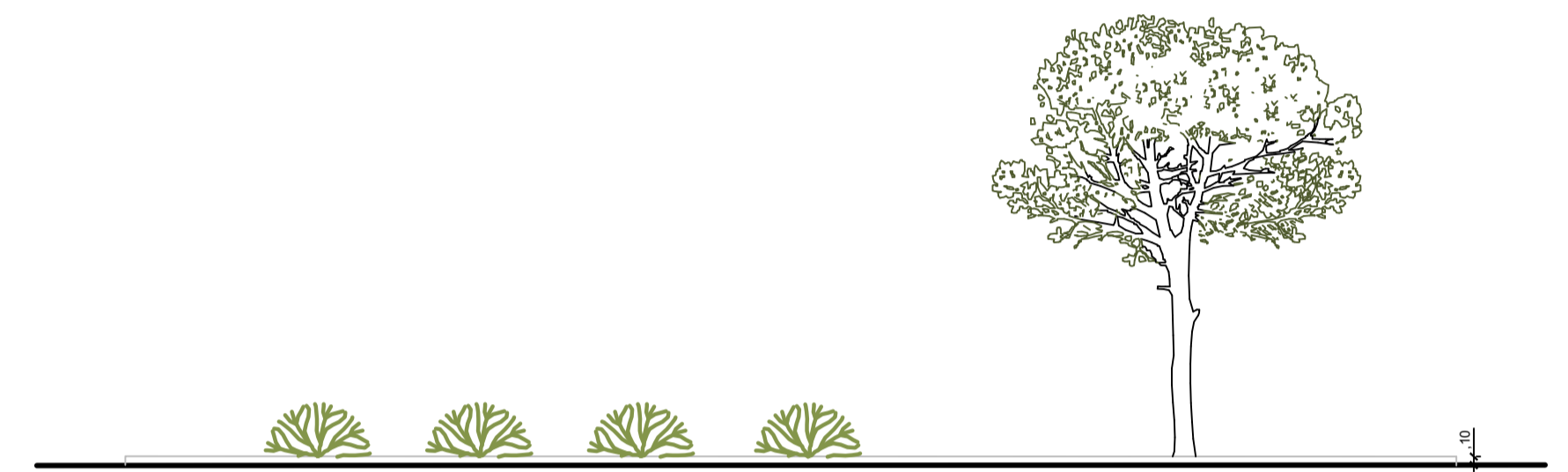

VISTA LONGITUDINAL (D10)

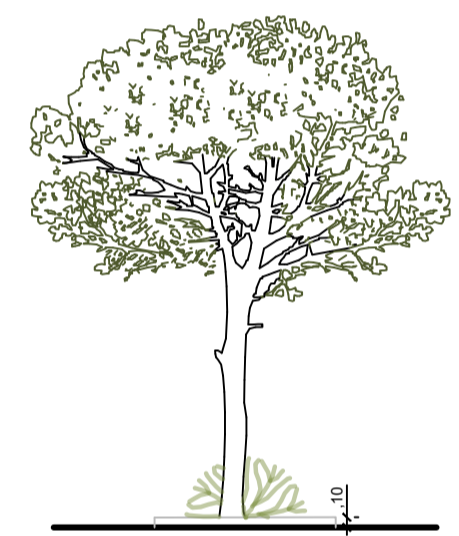

VISTA TRANSVERSAL (D10)

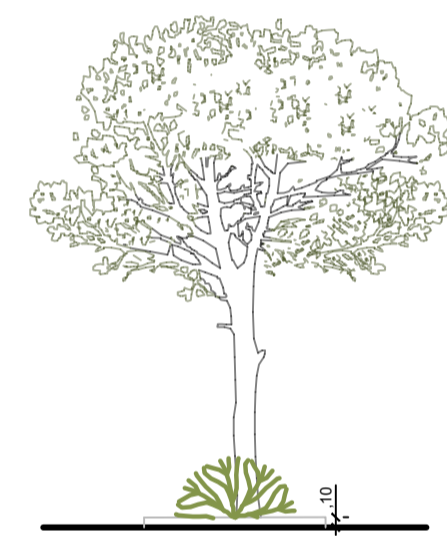

VISTA TRANSVERSAL (D10)

**DETALHE 10 - CANTEIRO PONTO DE ÔNIBUS**  
ESCALA 1:75

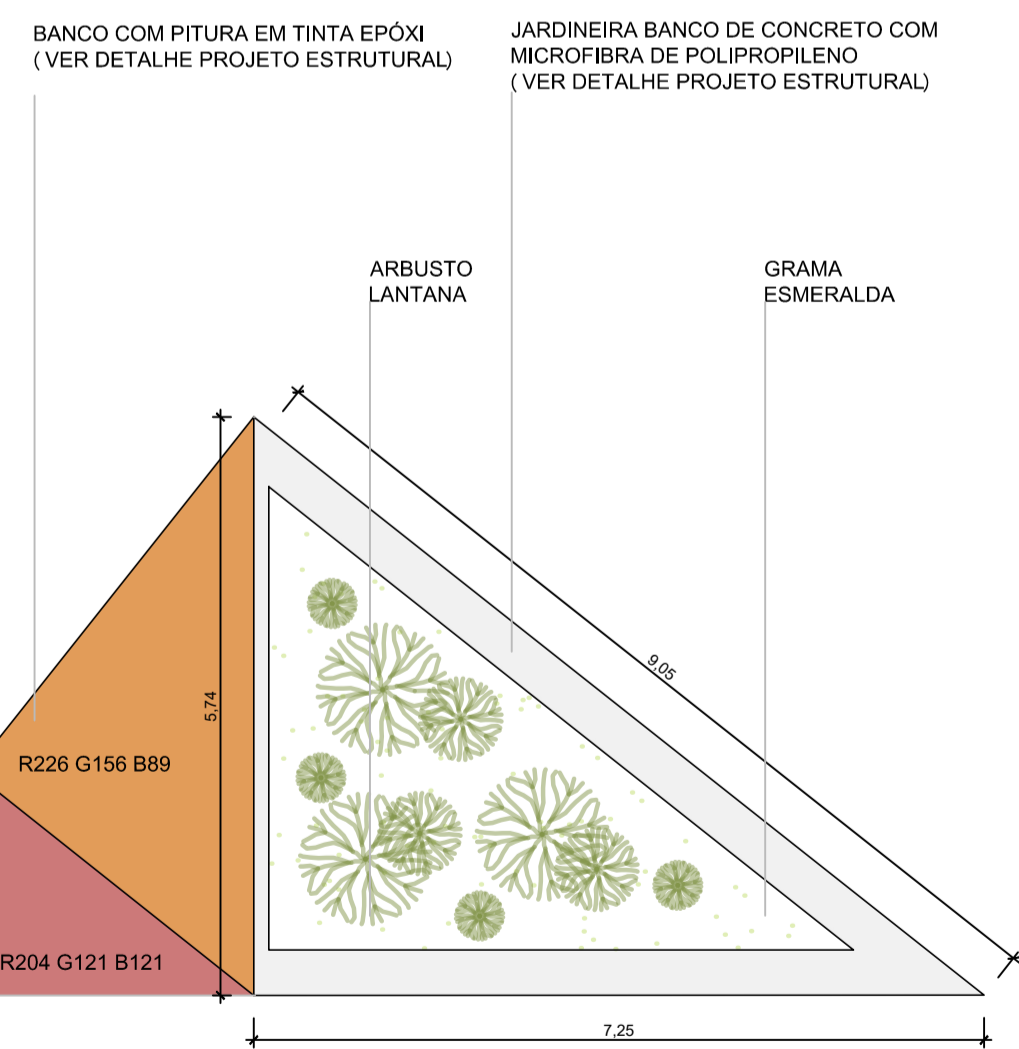

VISTA SUPERIOR (D11)

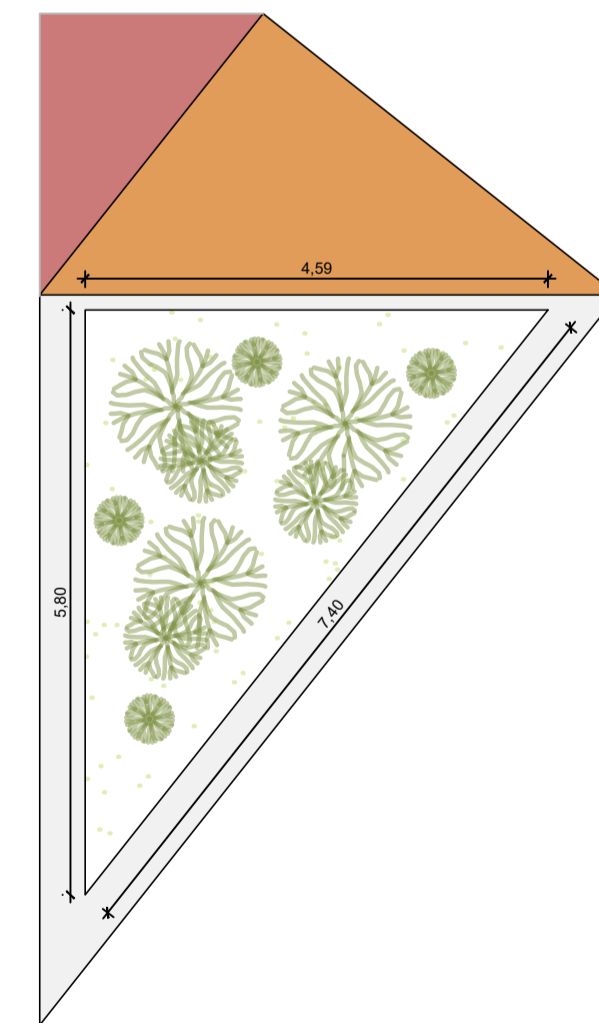

VISTA SUPERIOR (D11)

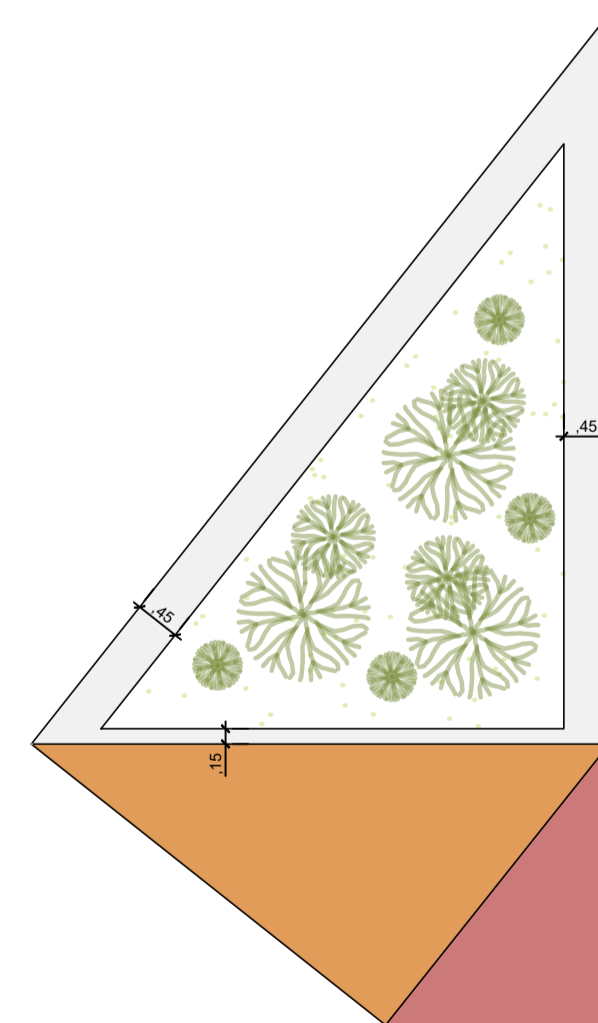

VISTA SUPERIOR (D11)

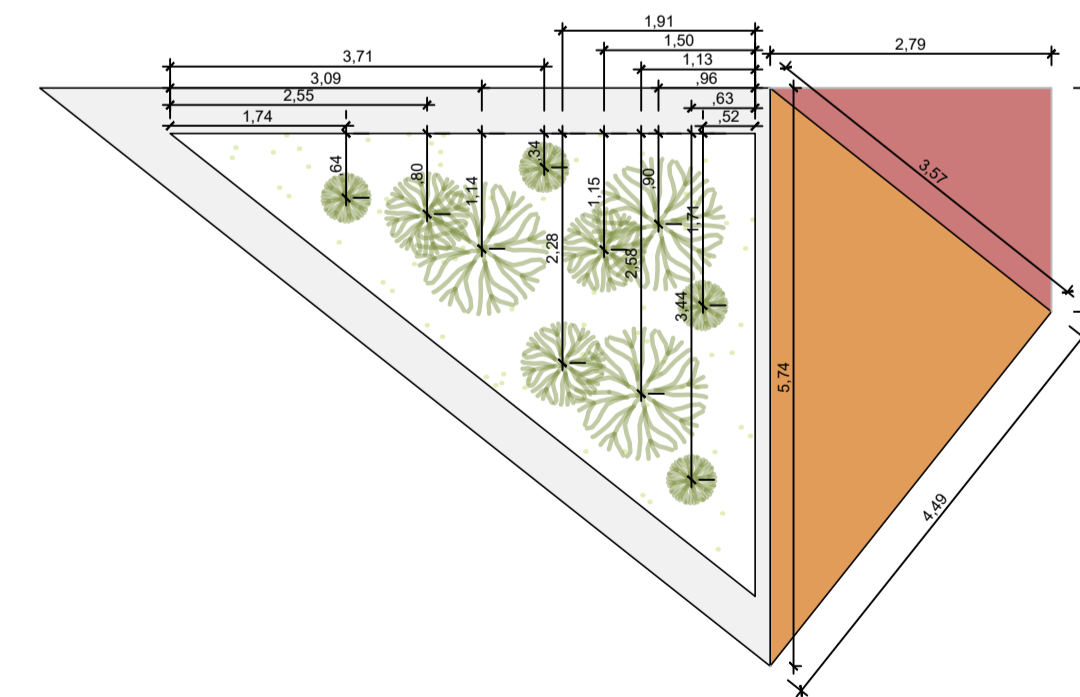

VISTA SUPERIOR (D11)



VISTA LONGITUDINAL (D11)

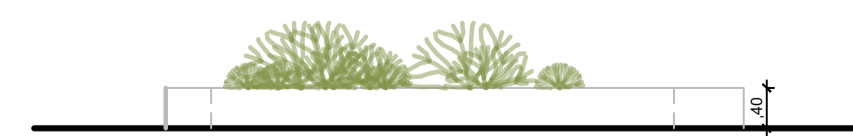

VISTA TRANSVERSAL (D11)

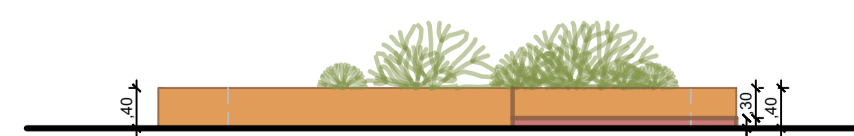

VISTA LONGITUDINAL (D11)



VISTA TRANSVERSAL (D11)

**DETALHE 11 - BANCO JARDINEIRA**  
ESCALA 1:75

**P.M.B.M.** SECRETARIA MUNICIPAL DE PLANEJAMENTO URBANO

**PROJETO DE ARQUITETURA** FOLHA: **06/08**

DESCRIÇÃO : IMPLANTAÇÃO E MODERNIZAÇÃO DE INFRAESTRUTURA PARA ESPORTE EDUCACIONAL, RECREATIVO E DE LAZER ( IMPLANTAÇÃO DE PRAÇA DE ESPORTES COM TÊNIS DE MESA NO GETÚLIO)

PROPRIETÁRIO : PREFEITURA MUNICIPAL DE BARRA MANSA

LOCAL : ESQUINA DA AVENIDA PRESIDENTE KENNEDY , COM A RUA JOSÉ FAGUNDES PINTO, GETÚLIO VARGAS, LOTE 02, BARRA MANSA - RJ

QUADRO DE ÁREAS	ZONA	SEVC
		USO
SELO DE APROVAÇÃO PMBM		
PINGUE-PONGUE -	172,98m <sup>2</sup>	
XADREZ -	36,23m <sup>2</sup>	
ATI (ACADEMIA) -	58,40m <sup>2</sup>	
CONVIVÊNCIA -	105,35m <sup>2</sup>	
CIRCULAÇÃO -	441,62m <sup>2</sup>	
ÁREA VERDE -	171,54m <sup>2</sup>	
TERRENO -	986,12m <sup>2</sup>	

COORDENADOR	AUTOR DO PROJETO	DESENHO	DATA
			28/02/19
REVISÃO 1	REVISÃO 2	Nº ART/RRT:	
REVISÃO 3	REVISÃO 4	Nº DO PROJETO:	CPU 28 02 19 AQ 002 07/10

**CARIMBO**

\_\_\_\_\_  
APROVAÇÃO SMPU